

SHIELDED SMD POWER INDUCTORS / SSR TYPE

FEATURES

- ◆ Magnetically shielded.
- ◆ Low DC resistance.
- ◆ Suitable for large currents.
- ◆ Various high power inductors are superior to be high saturation for surface mounting



APPLICATIONS

- ◆ Power supply for OA equipment.
- ◆ Portable communication equipment.
- ◆ LCD televisions, Notebook.
- ◆ DC to DC converters, etc.

ORDERING CODE

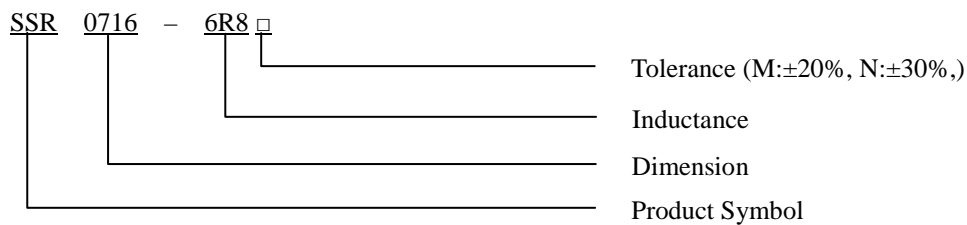

DIMENSIONS (UNIT: mm)

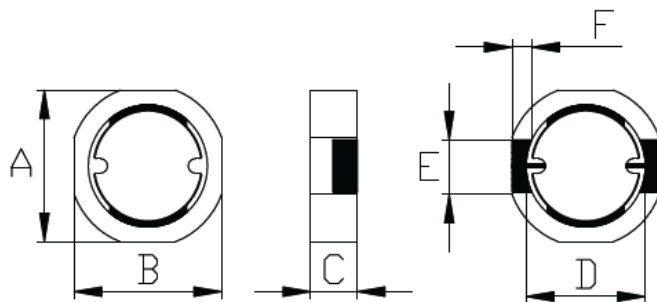

A	8.0 (MAX)	m/m
B	7.6 (MAX)	m/m
C	1.6 (MAX)	m/m
D	5.9 (REF)	m/m
E	2.5 (REF)	m/m
F	0.7 (REF)	m/m

ELECTRICAL CHARACTERISTICS FOR SSR0716

Part No.	Inductance (uH)	Test Frequency	RDC (mΩ)	IDC (A)
SSR0716-4R7 □	4.7	100KHZ	57.2	2.4
SSR0716-6R8 □	6.8	100KHZ	76.7	2.1